

# Temperature Check Stations

## Tuesday-Friday

### 7:30am-7:55am

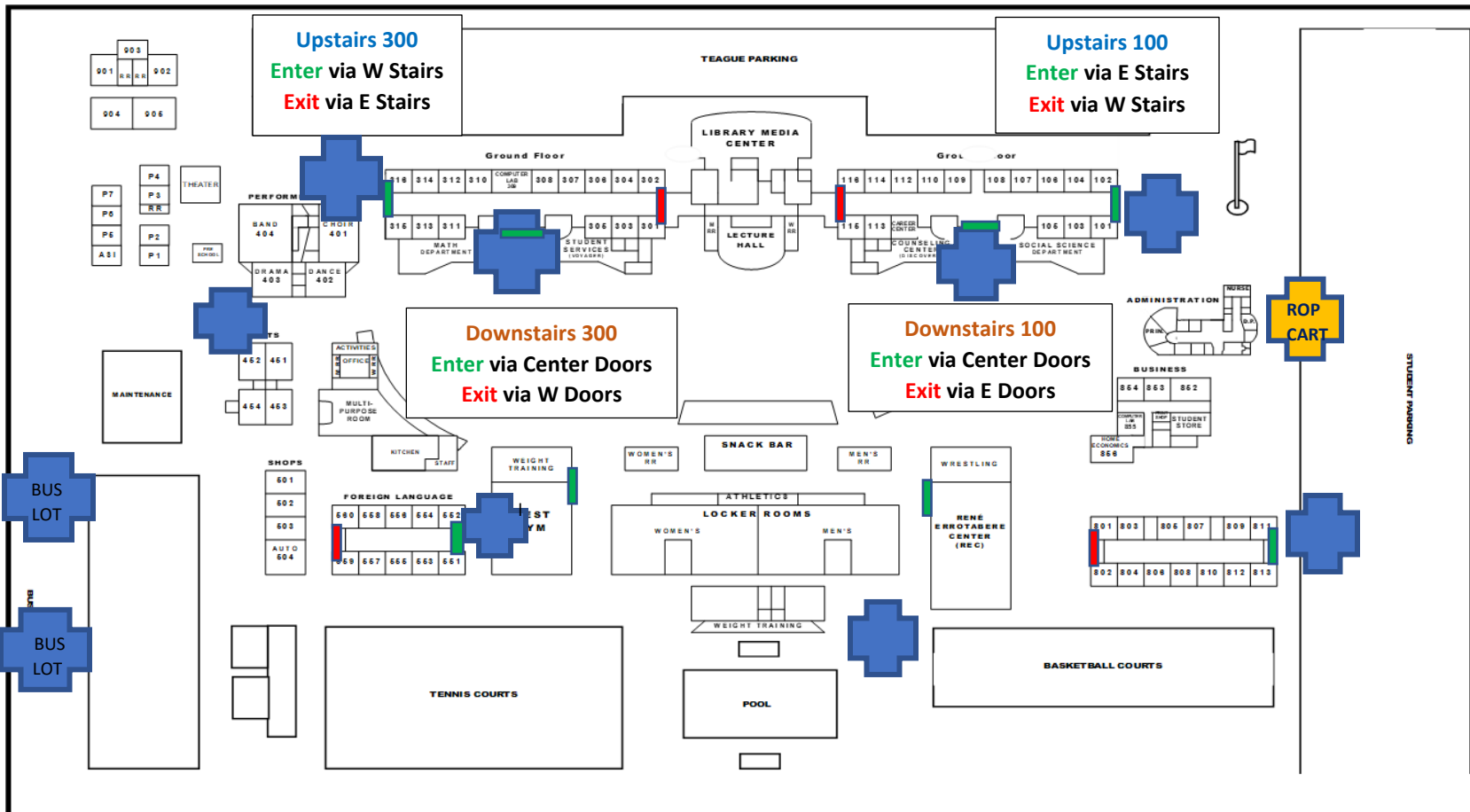

Temperature Check Stations



Entrance



Exit Only

### Procedures

- Students must complete the health screening at home prior to coming to school.
- Students need to report to the temp check station closest to their 1<sup>st</sup> class of the day.
- Student ID card will be scanned, temperature taken, given a colored wristband (wristband color will be different each day).
- Late students will go to the Attendance Windows to get checked and get a Tardy pass.
- ROP/CART students will go the ROP/CART temp check station by the main office.
- Once cleared, students will be directed to go to class.
- Students with symptoms will be escorted to the Care Room. Health office staff will contact parents.